

Proposed Fence



- Notes:**
- Do not scale from this drawing. All dimensions are in metres, unless stated otherwise.
 - This topographical drawing was received by O'Connor drawing number (20-01-1), and drawing date (12.03.2020).
 - Highway boundary information has been provided by Gloucestershire County Council (GCC) and has been overlaid by Rappor onto the Topographical & Ordnance survey on a best fit basis.
 - Ordnance Survey, (c) Crown Copyright 2020. All rights reserved. Licence number 10022432.

Key:

- Application Site Boundary
- Client Land Ownership
- Highway Boundary (Transcribed Highway Boundary based on GCC plan)
- 2.4m x 26.1m Northern Visibility Splay (Based on a Recorded 85th Percentile Speed of 21mph)
- 2.4m x 33.73m Southern Visibility Splay (Based on a Recorded 85th Percentile Speed of 25mph)

| Rev | Date | Details | Drawn By | Checked By |
|-----|----------|---|----------|------------|
| D | 06.04.23 | Proposed turning area added | EE | MG |
| C | 26.03.23 | Revised all details to the date of Proposed Date | IRG | MG |
| B | 05.12.22 | Updated Proposed Project Design | FA | MG |
| A | 26.11.22 | Initial Client Land Ownership & Proposed Site Plans | FA | MG |

rappor
 infrastructure and environmental consultants
 rappor.co.uk

CLIENT: [REDACTED]

PROJECT:
**South Park,
 Cheltenham**

TITLE:
Proposed Site Layout

STATUS:
PLANNING

| | | | | |
|-------------|-------------|-----------|----------|-----------|
| SCALE @ A3: | DATE: | DRAWN: | CHECKED: | APPROVED: |
| 1:500 | 18.11.22 | FA | MG | MG |
| JOB NO: | DRAWING NO: | REVISION: | | |
| 21-0468 | SK04 | | D | |

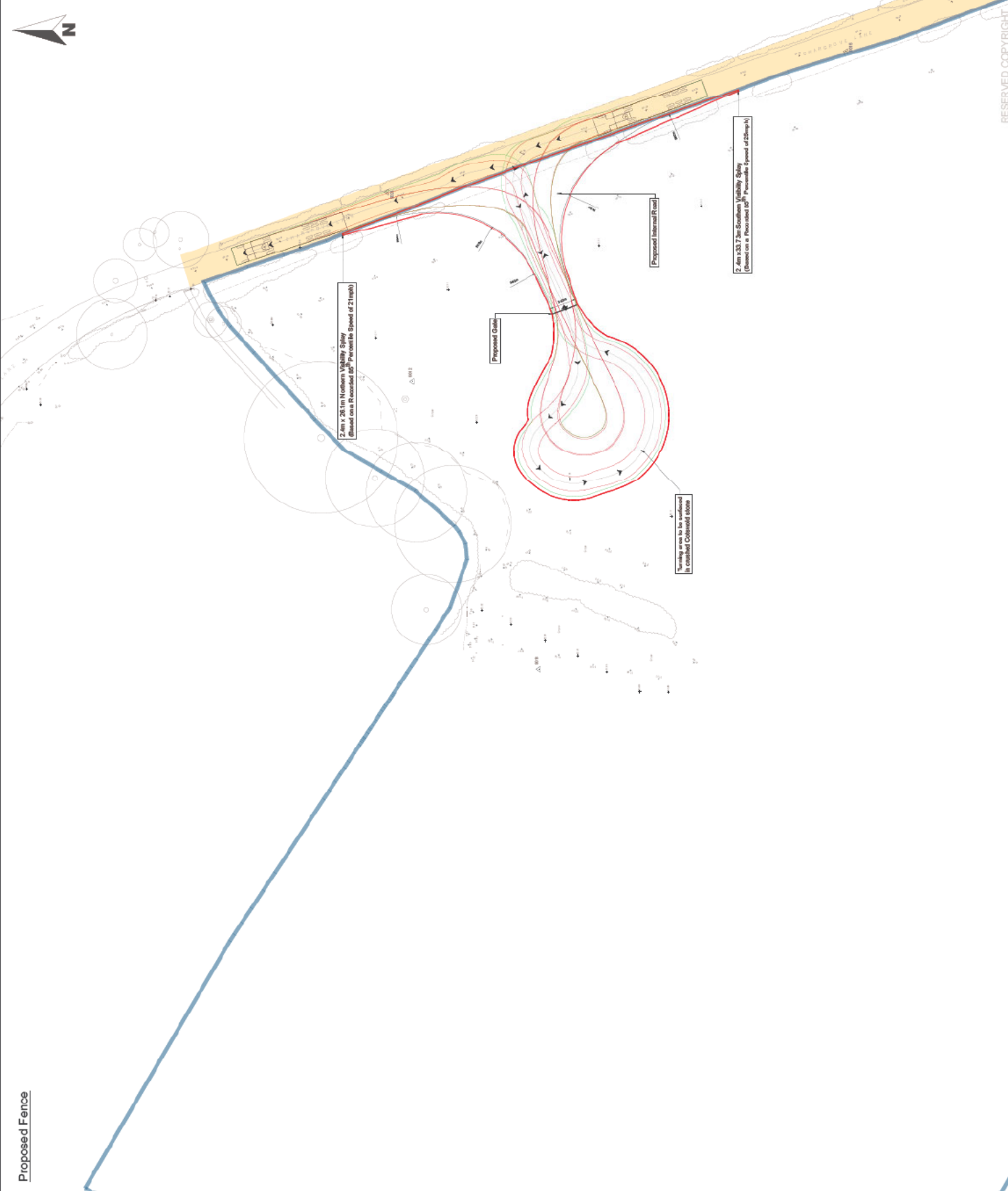

RESERVED COPYRIGHT

Notes:

1. Do not scale from this drawing. All dimensions are in metres, unless stated otherwise.
2. This topographical drawing was received by O'Connor drawing number (20-01-1), and drawing date (12.03.2020).
3. Highway boundary information has been provided by Gloucestershire County Council (GCC) and has been overlaid by Rappor onto the Topographical & Ordnance Survey on a best fit basis.
4. Ordnance Survey, (c) Crown Copyright 2020. All rights reserved. Licence number 10022432.

Key:

- Application Site Boundary
- Client Land Ownership
- Highway Boundary (Transcribed Highway Boundary based on GCC plan)

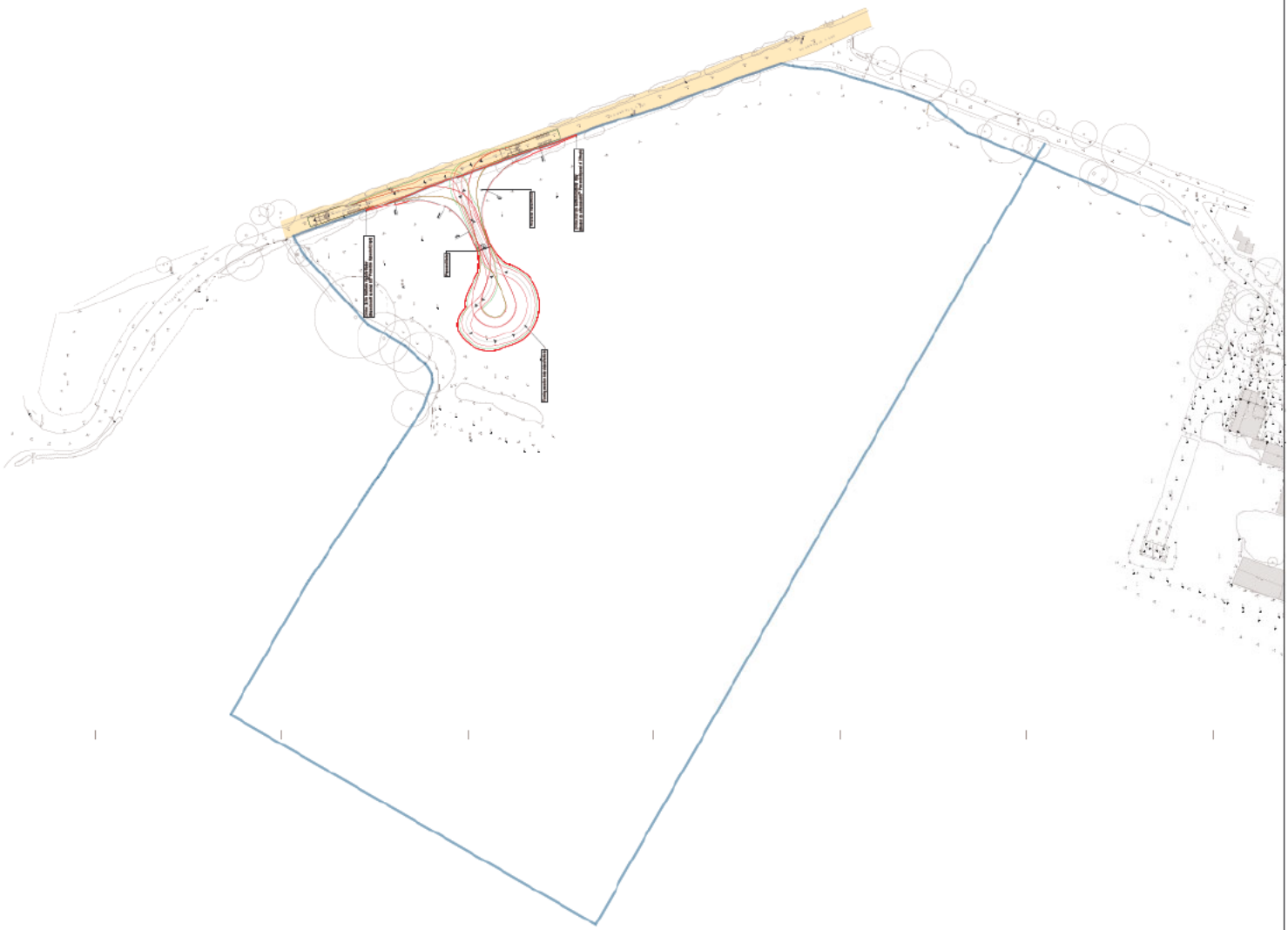

| Rev | Date | Drawn By | Checked By |
|-----|----------|----------|------------|
| 0 | 06.04.23 | MG | MG |
| 1 | 20.11.23 | FA | MG |

Proposed turning area added!
Updated Client Land Ownership & Highway Boundary

rappor

infrastructure and environmental consultants

rappor.co.uk

CLIENT: [Redacted]

PROJECT:
South Park,
Cheltenham

TITLE:
Site Location Plan

STATUS: **PLANNING**

| SCALE @ A3 | DATE | DRAWN: | CHECKED: | APPROVED: |
|------------|----------|--------|----------|-----------|
| 1:1250 | 18.11.22 | FA | MG | MG |

| JOB NO. | DRAWING NO. | REVISION: |
|---------|-------------|-----------|
| 21-0468 | SK03 | B |

- Notes:**
- Do not scale from this drawing. All dimensions are in metres, unless stated otherwise.
 - This topographical drawing was received by O'Connor drawing number (20-01-1), and drawing date (12.03.2020).
 - Highway boundary information has been provided by Gloucestershire County Council (GCC) and has been overlaid by Rappor onto the Topographical & Ordnance survey on a best fit basis.
 - Ordnance Survey, (c) Crown Copyright 2020. All rights reserved. Licence number 10022432.

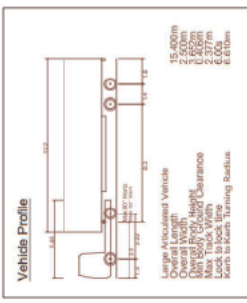

Key:

- Application Site Boundary
- Client Land Ownership

| Rev | Date | Drawn | Checked | Origin |
|-----|----------|-----------------------------|---------|--------|
| 0 | 06.04.23 | Proposed turning area added | SE MG | MG |
| 1 | 24.03.23 | Updated to reflect proposed | MM MG | MG |

rappor

infrastructure and environmental consultants

rappor.co.uk

CLIENT: [Redacted]

PROJECT: South Park, Cheltenham

TITLE: Swept Path Analysis
15.4m Articulated Vehicle

STATUS: **PLANNING**

| SCALE @ A3 | DATE | DRAWN | CHECKED | APPROVED |
|------------|----------|-------|---------|----------|
| 1:250 | 18.11.22 | FA | MG | MG |

JOB NO.: 21-0468 **DRAWING NO.:** SP04 **REVISION:** B

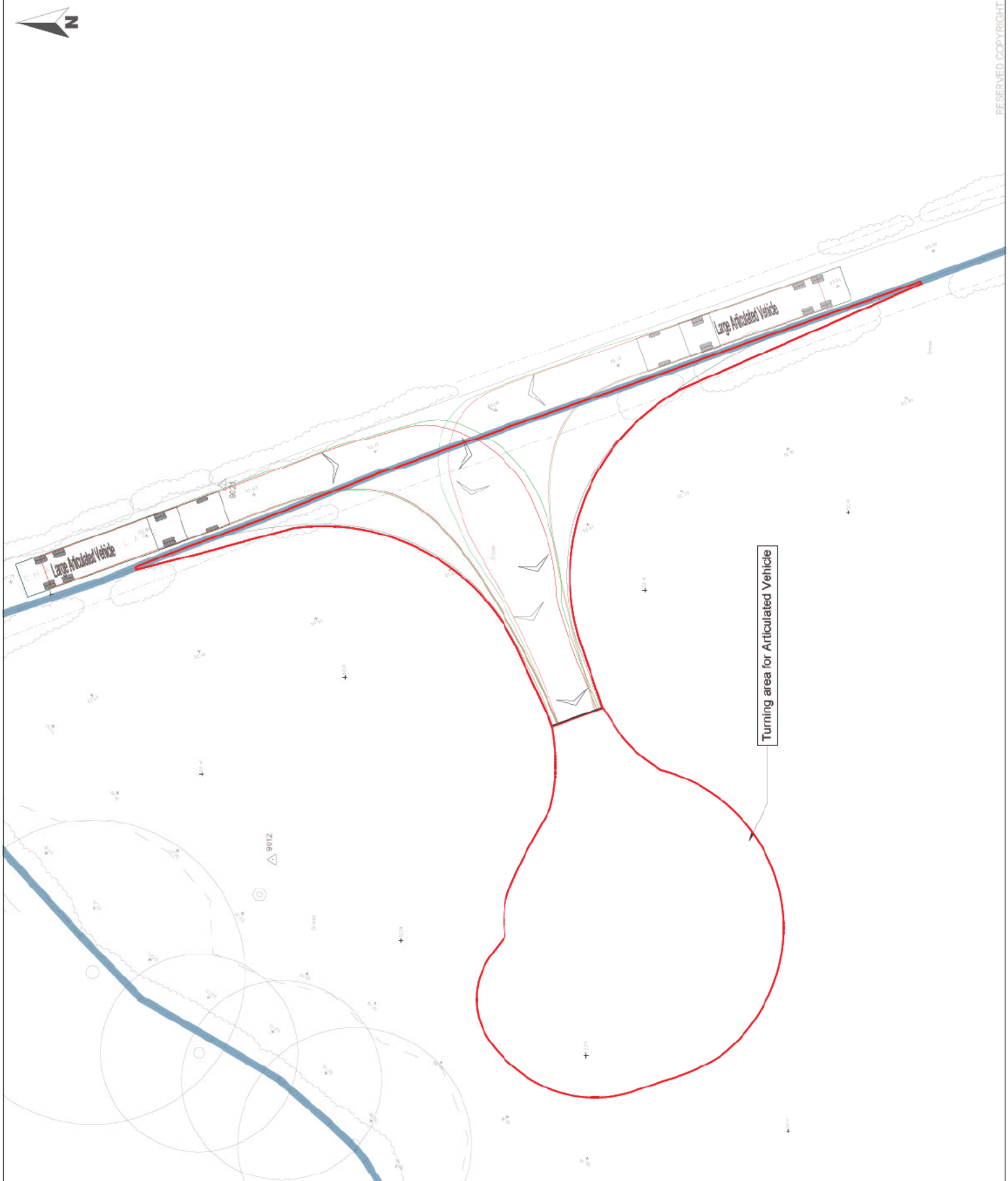

Client: [REDACTED]
 Site: Chargrove Lane, South Park, GL51 4XD
 Drawing Title: New Agricultural Access Landscaping Plan
 Scale: 1:500 @ A3
 Dwg No: SPAL-APR23
 Drawn by: NJJ
 Date: April 23



Hutchinson Arboriculture
 Horticulture & Landscaping
 T4: 07527 65101
 Email: Owen@hutcharb.co.uk
 © Hutchinson Arboriculture

| | | |
|------|--|--|
| Key: | | Tree trunk, number and Root Protection Areas (RPA) |
| | | Retention callouts based on BS 5637 Table 1:- |
| | | Trees removal for safety |
| | | Trees removed for development |
| | | New planting |

Existing Tree notes.

- H36 = predominantly hawthorn trimmed hedge.
- Existing trees north of deep ditch are off-site & unaffected by proposal.
- H41 = hawthorn, blackthorn untrimmed edge of copse.
- T43-T45 = crack willows leaning over ditch.
- T46 = elm.
- T42, T47, T48, T49 = big oaks.
- H50 = trimmed field hedge.

Proposed landscaping.

Remove 2.5m of existing hedging for gateway and visibility splays.
 Cut 5m gap in H50 for new gateway to replace existing gateway close to ditch.

New / replacement Hedging:

- 66m of new / replacement hedging, planted at five plants/m:
 - Hawthorn x 150
 - Hazel x 25
 - Field maple x 25
 - Wild privet x 25
 - Spindle x 25
 - Holly x 25
- Plants 60-80cm transplants in 60cm spirals with canes, holly potted 30cm in 60cm tree shelter with stake.

New tree planting:

- Oak x 6
- Field maple x 3.
- Trees 80-120cm in 1.2m tree shelters with 1.5m stakes.

Maintenance:

- Spot or band weed with Roundup years 1-3 post planting original or replacements.
- Control noxious weeds.
- Replace failures and maintain guards and fencing as required to achieve 90% healthy full stocking by year 5.

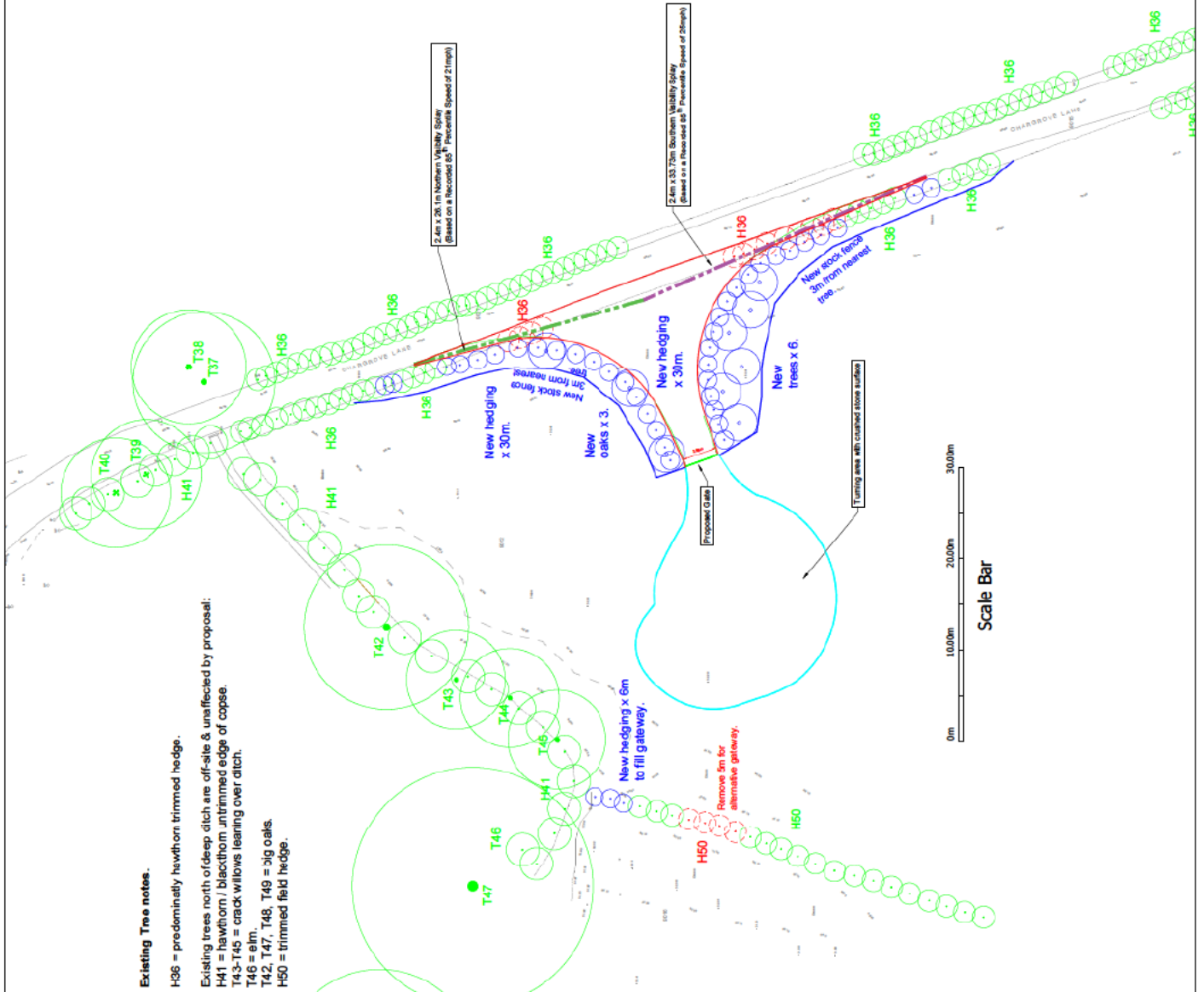

Scale Bar

Scale

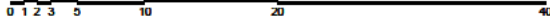

Notes

- 1) Do not scale directly from this drawing.
- 2) This drawing is to be read in conjunction with all other relevant M-P drawings and information supplied by other consultants.
- 3) Hatch patterns displayed on this drawing are indicative only and do not represent actual paving units or material sizes.
- 4) All tree planting in proximity to buildings to be checked by engineers to ensure foundation detailing is appropriate.

| | | | |
|---------------------------------------|----------------|----------------|--------------|
| Approved/Issued: | | DATE: 01/08/23 | BY: AH |
| Author/Designer/Checker/Revised: | | DATE: 01/08/23 | BY: AH |
| Project: Access Track, Chargrove Lane | | | |
| Client: [REDACTED] | | | |
| Title: Landscaper Proposals | | | |
| Drawing number: 231326.101 | | Sheet: B | |
| Status: FOR PLANNING | | | |
| Drawn By: DB | Checked By: AH | Date: 01/08/23 | Scale: 1/200 |

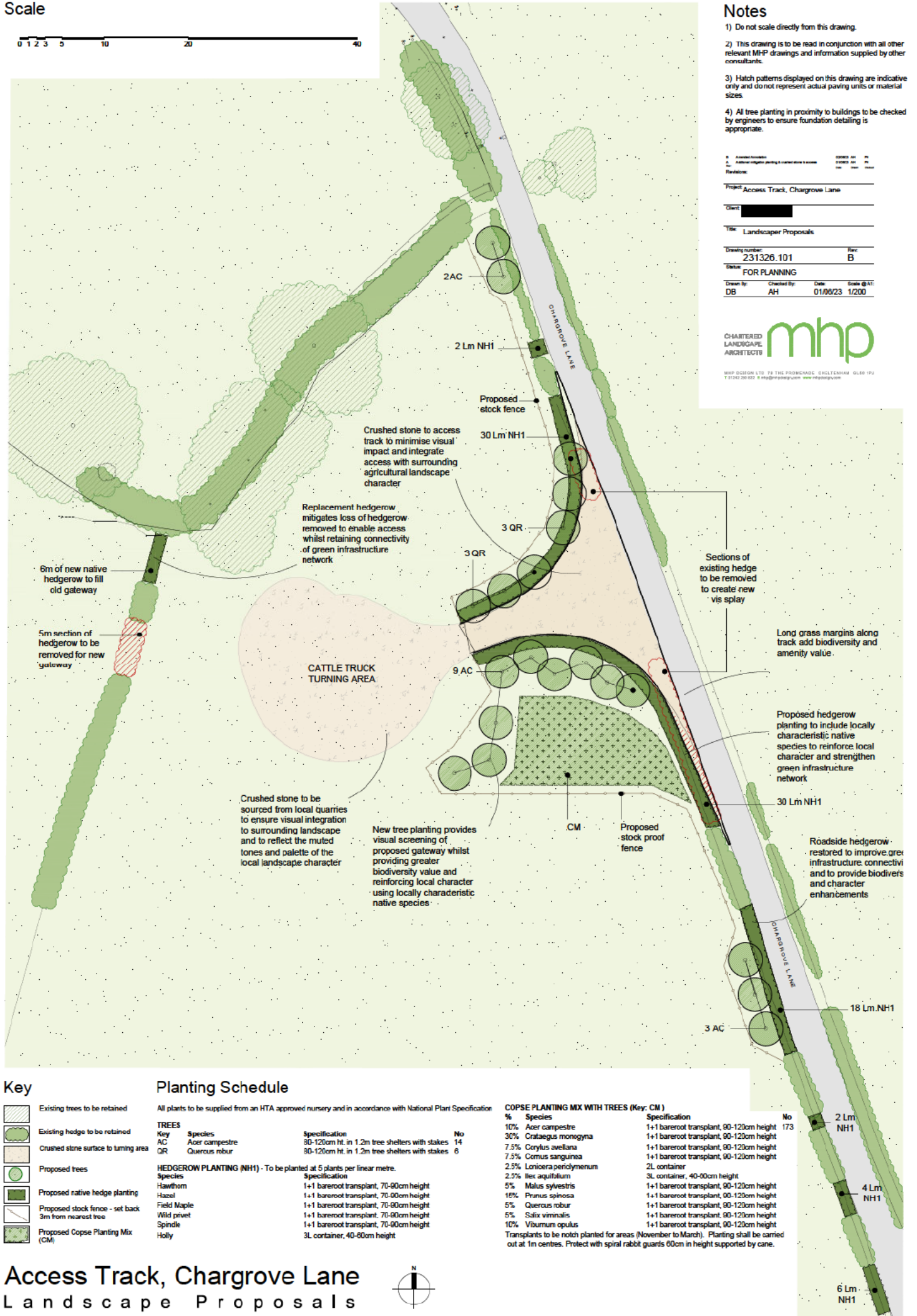

Key

- Existing trees to be retained
- Existing hedge to be retained
- Crushed stone surface to turning area
- Proposed trees
- Proposed native hedge planting
- Proposed stock fence - set back 3m from nearest tree
- Proposed Copse Planting Mix (CM)

Planting Schedule

All plants to be supplied from an HTA approved nursery and in accordance with National Plant Specification

| Key | Species | Specification | No |
|-----|----------------|--|----|
| AC | Acer campestre | 80-120cm ht. in 1.2m tree shelters with stakes | 14 |
| QR | Quercus robur | 80-120cm ht. in 1.2m tree shelters with stakes | 6 |

HEDGEROW PLANTING (NH1) - To be planted at 5 plants per linear metre.

| Species | Specification |
|-------------|---|
| Hawthorn | 1+1 bareroot transplant, 70-90cm height |
| Hazel | 1+1 bareroot transplant, 70-90cm height |
| Field Maple | 1+1 bareroot transplant, 70-90cm height |
| Wild privet | 1+1 bareroot transplant, 70-90cm height |
| Spindle | 1+1 bareroot transplant, 70-90cm height |
| Holly | 3L container, 40-60cm height |

COPSE PLANTING MIX WITH TREES (Key: CM)

| % | Species | Specification | No |
|------|-----------------------|--|-----|
| 10% | Acer campestre | 1+1 bareroot transplant, 90-120cm height | 173 |
| 30% | Crataegus monogyna | 1+1 bareroot transplant, 90-120cm height | |
| 7.5% | Corylus avellana | 1+1 bareroot transplant, 90-120cm height | |
| 7.5% | Cornus sanguinea | 1+1 bareroot transplant, 90-120cm height | |
| 2.5% | Lonicera periclymenum | 2L container | |
| 2.5% | Ilex aquifolium | 3L container, 40-60cm height | |
| 5% | Malus sylvestris | 1+1 bareroot transplant, 90-120cm height | |
| 16% | Prunus spinosa | 1+1 bareroot transplant, 90-120cm height | |
| 5% | Quercus robur | 1+1 bareroot transplant, 90-120cm height | |
| 5% | Salix viminalis | 1+1 bareroot transplant, 90-120cm height | |
| 10% | Viburnum opulus | 1+1 bareroot transplant, 90-120cm height | |

Transplants to be notched for planting (November to March). Planting shall be carried out at 1m centres. Protect with spiral rabbit guards 60cm in height supported by cane.

Access Track, Chargrove Lane
Landscape Proposals





